

The logo for MODU-AL, featuring a blue square icon with four lines extending from its corners, followed by the text 'MODU-AL' in a blue, sans-serif font, with 'AL' in red and a registered trademark symbol (®) to the right.

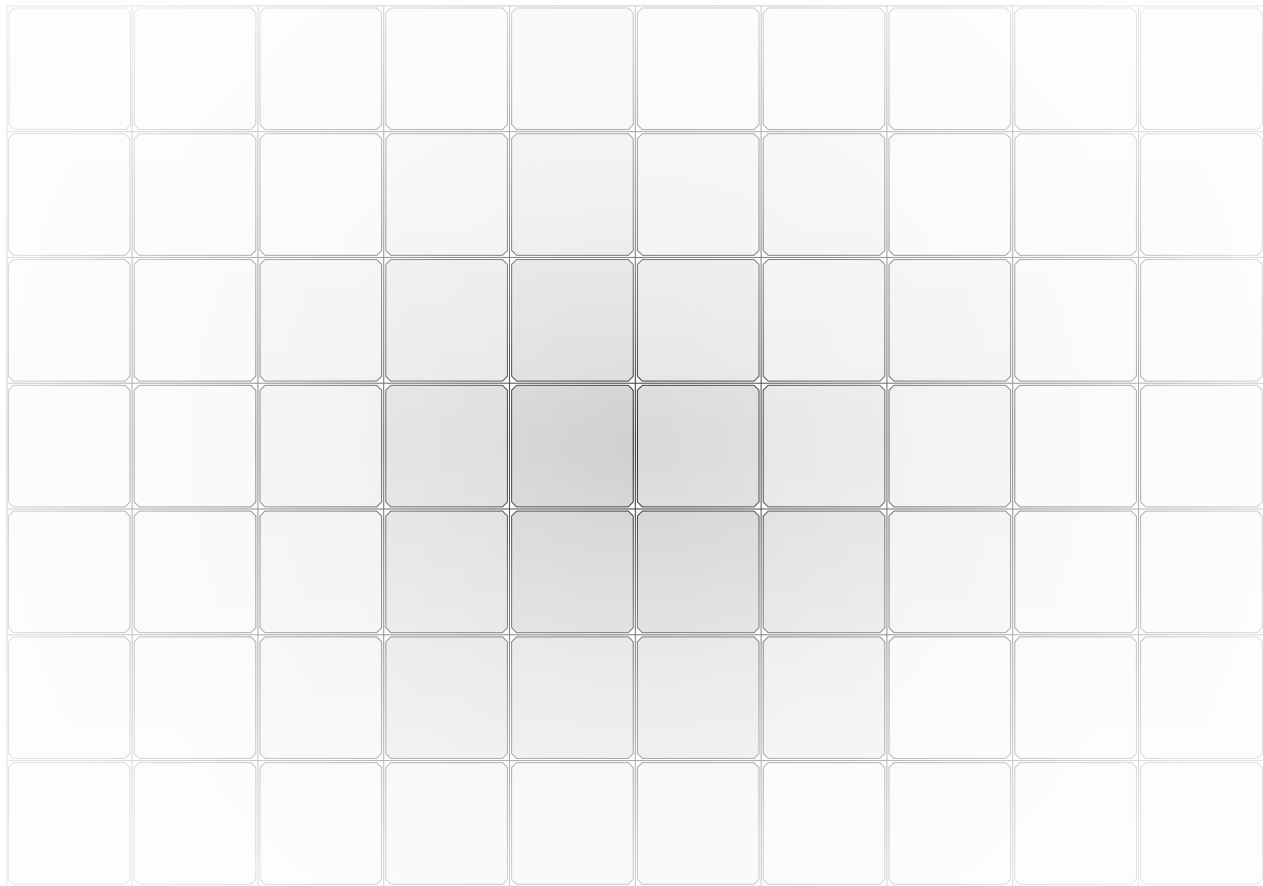



AMV SLOVAKIA

AMV SLOVAKIA

AMV Slovakia, located in Nové Zámky, Slovak Republic, is a family-owned company with a 30-year tradition of manufacturing gravestones and cemetery accessories. Business representatives in all European countries, as well as a number of patents, testify to the progressivity of the company and the good name of its products.

Technological equipment, production and human potential provide production capabilities without the need for co-operation. In-house product design, mould and tool construction, casting, moulding, surface finishing, assembly and expedition to customers are the prerequisites for creating unrivalled product superiority and value-added customer services.





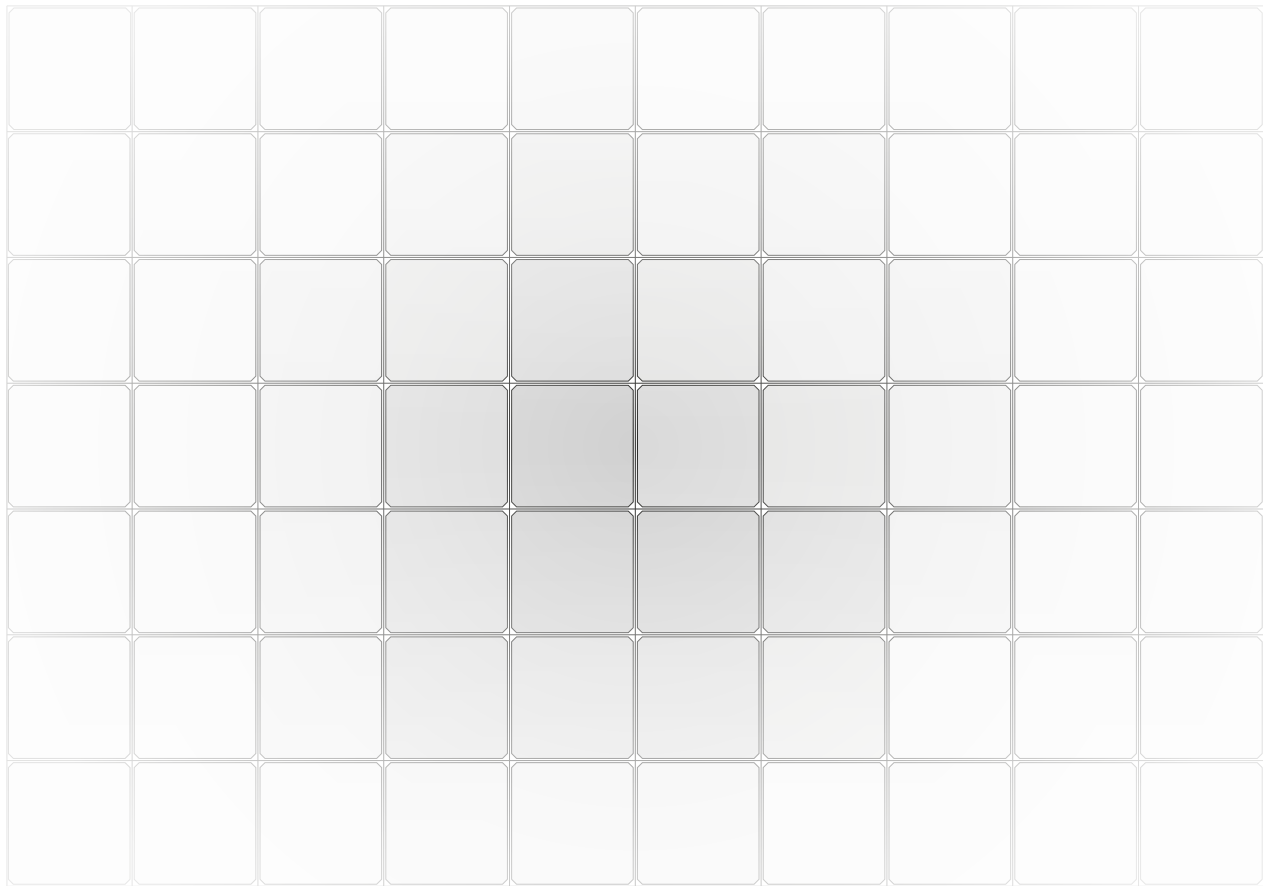



CURRENT STATE

CURRENT STATE

Lifestyle Change – Grave care and maintenance

The hasty lifestyle, as well as the greater migration of young people, pursuing their studies or work, make us think about who will take care of the “big” graves in the future, clean and maintain them.

- our modular funeral urn system ensures a simpler, faster and financially less demanding maintenance of gravesites



Lack of space

Cemeteries are becoming overcrowded. Finding enough land or suitable places for further grave sites is a serious problem in most cities, towns and villages.

- in cemeteries, we can find and allocate a site to place a modular urn system

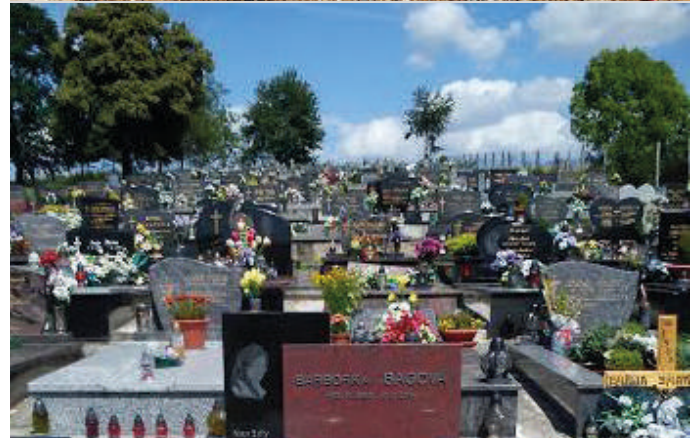

Inelegant arrangement of existing graves in cemeteries

Differences in dimensions, shapes and various positions cause visual confusion in cemeteries. Neighbours want to have a “nicer” grave and do not hesitate to use styles that we might call tasteless. Such solutions, looking at most of today’s cemeteries, do not create a sense of harmony.

- modular urn systems ensure aesthetics, functionality and purity of lines



Financial costs

Demands for new grave sites bring the municipalities more costs. It is not just about the lack of space, but also about the need to build a financially demanding infrastructure.

- modular urn systems offer to make use of the existing space at cemeteries, especially economy in the number of graves per m², as the present ratio is 10:1



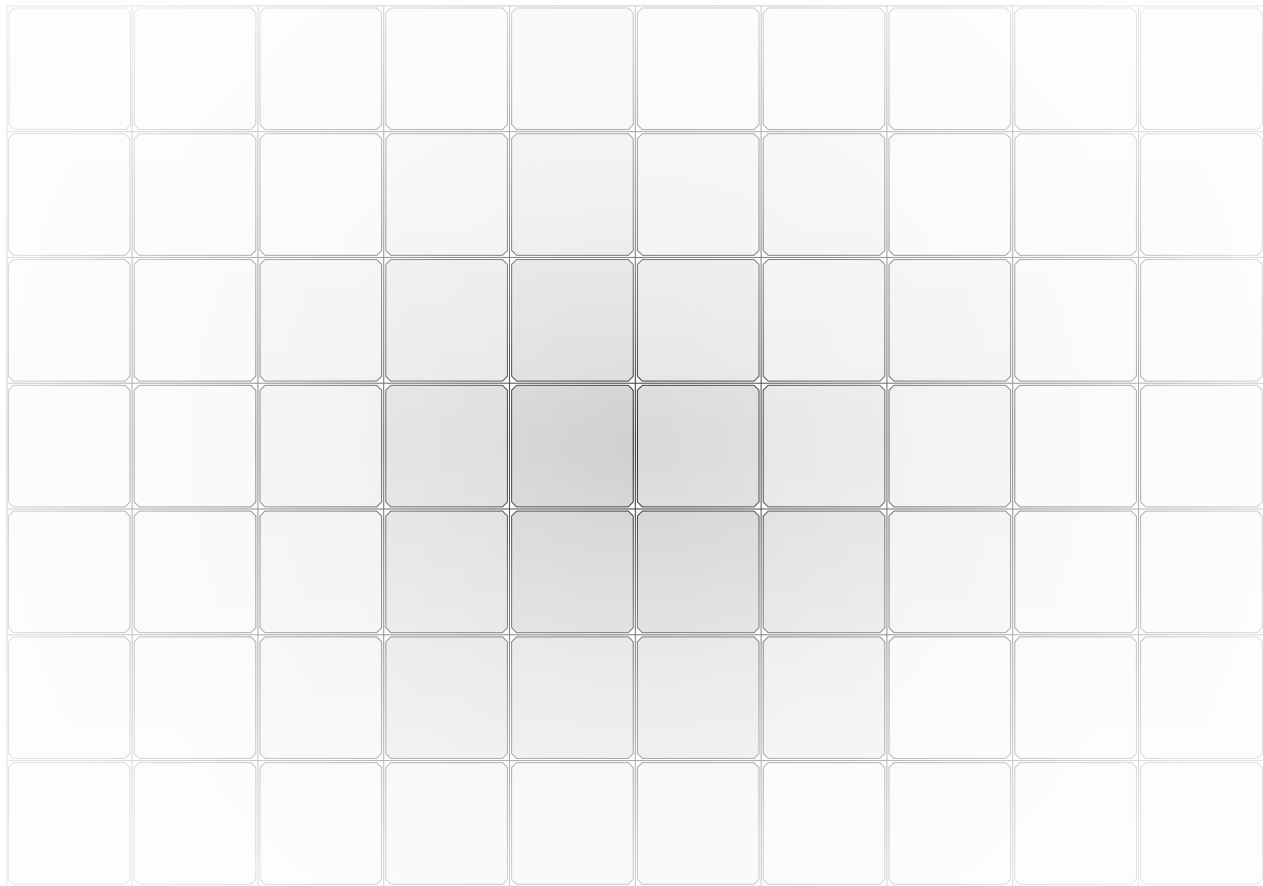



TRENDS IN THE WORLD

TRENDS IN THE WORLD

Current trends put emphases on the dignity of the resting place, which is not based solely on the creation of the “biggest possible” grave. Cemeteries create places, not graves. Our goal is to create a park that will breathe with harmony and dignity, a proper resting place.

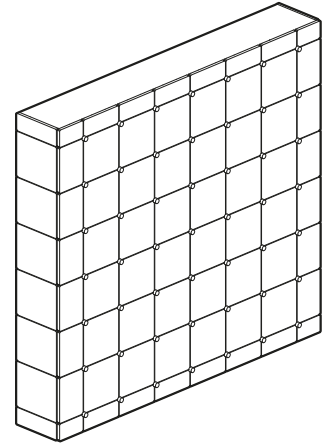
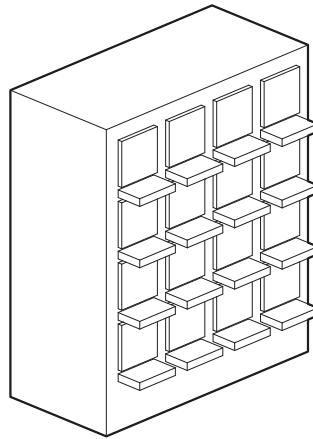
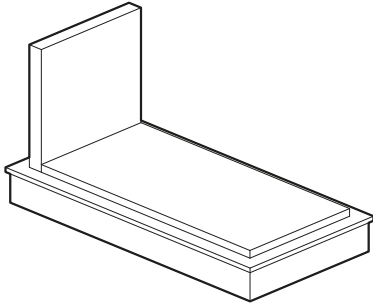

A gradual transition from a “big” grave that occupies a lot of space and is financially demanding to modular urn walls, requiring less space and investment (per a gravesite unit).



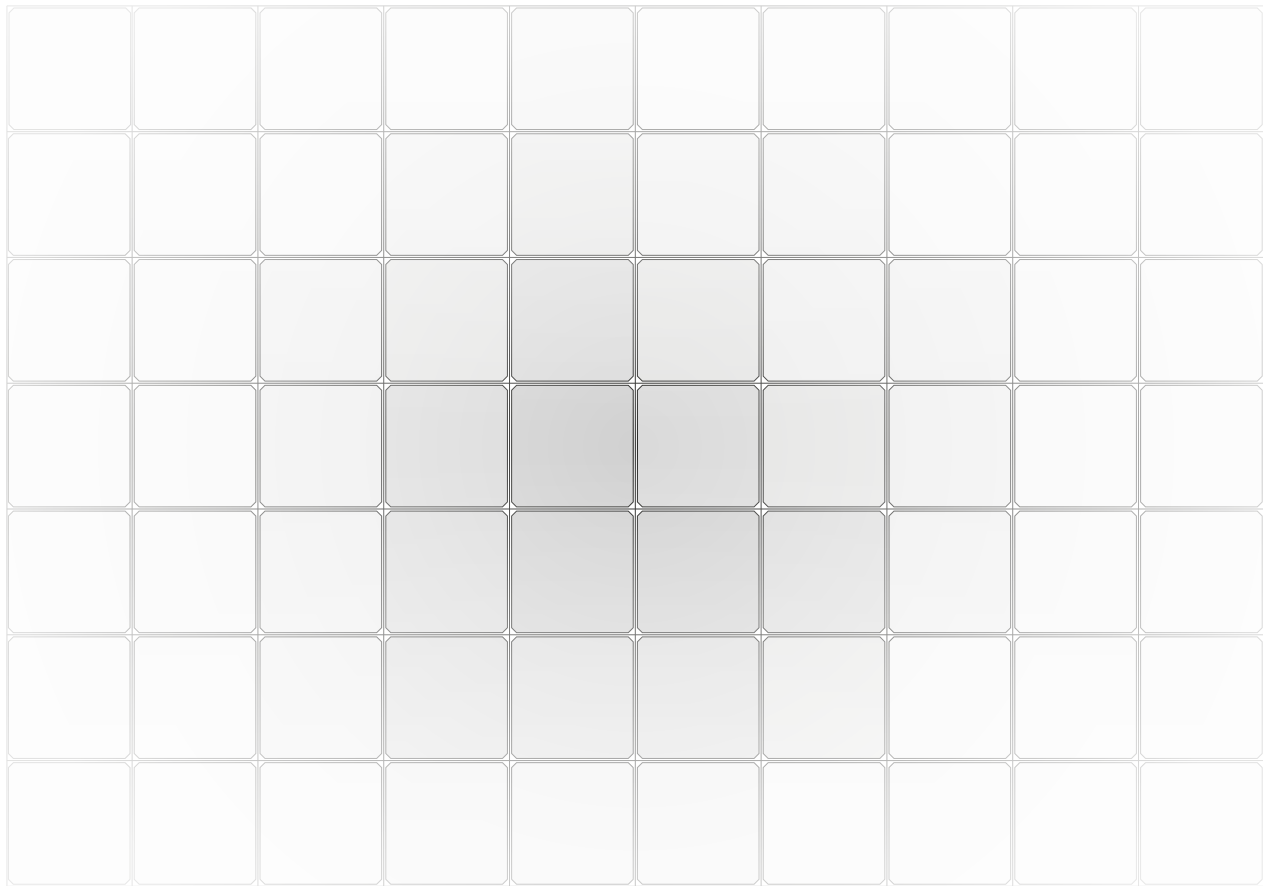



MODU-AL SYSTEM

MODU-AL SYSTEM

We are presenting you our MODU-AL system. It is a modular, aesthetic, constructionally and economically advantageous system of storing the remains of the deceased. Nowadays, when there is a shortage of space in cemeteries, this system brings new possibilities within the framework of cemetery architecture.

The implementation of the MODU-AL system is time and financially much less demanding than the complicated concrete construction of columbaria. The modularity of the system makes it possible to create different sizes, additional design options and groupings. Solutions are countless. MODU-AL system is offered in five solutions:

- 1. CREMATION NICHE (GRAVE-MOUNTED)**
- 2. URN GRAVE**
- 3. PILLAR COLUMBARIUM**
- 4. COLUMBARIUM WALL**
- 5. CRYPT MAUSOLEUM
WITH CREMATION NICHES**

! NEW !

Each niche unit is supplied with electricity:

- each lantern is illuminated
- a camera system to monitor the site and provide more security
- control and inspection via mobile phone, prepayment of electricity as an option
- gravesite insurance

Most of these solutions can be extended and modified according to customer needs.

CREMATION NICHE

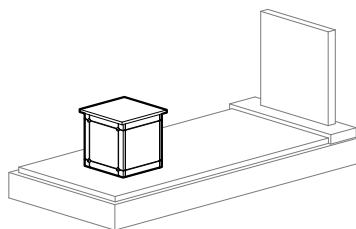

URN GRAVE

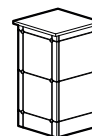

PILLAR COLUMBARIUM

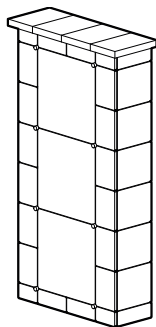

COLUMBARIUM WALL

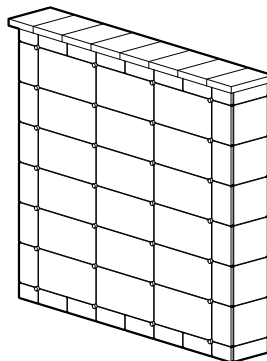

COLUMBARIUM MEMORIAL BUILDING

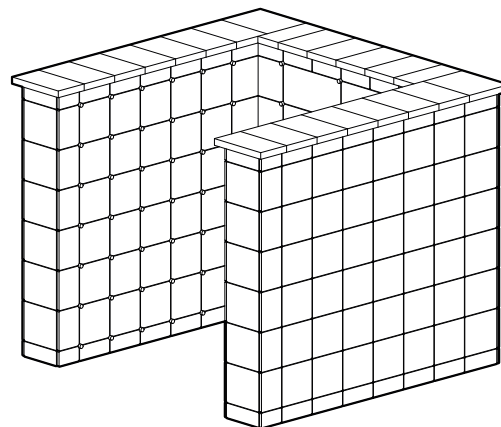

MODU-AL SYSTEM

HOW THE MODU-AL SYSTEM WORKS

CONSTRUCTION

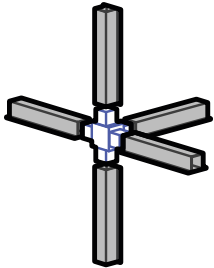

The construction is made of connecting elements and aluminium profiles.

CONSTRUCTION

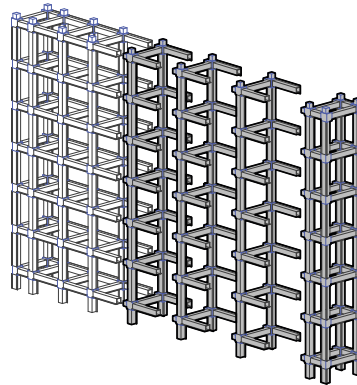

This way the structure is modular and easily extendable.

PERIMETER STONE PLATES

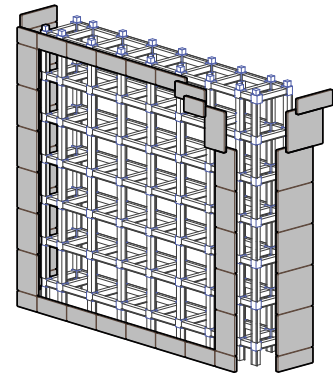

The perimeter and sidewall stone plates are rigidly mounted to the structure.

ROOF PLATES

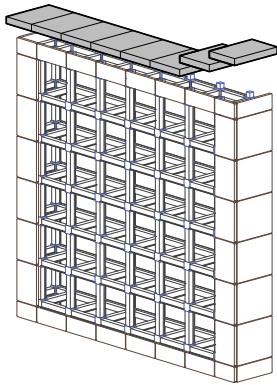

The structure is fitted with roof plates of the same material as the perimeter ones.

FACE PLATES

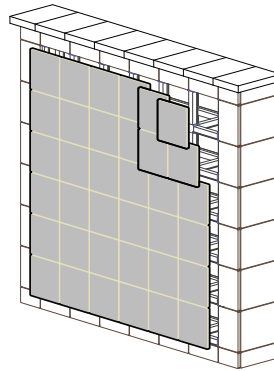

Subsequently, the face plates can be fixed, each one, individually, they are all in the same decor that is not identical to the perimeter.

ROSETTES

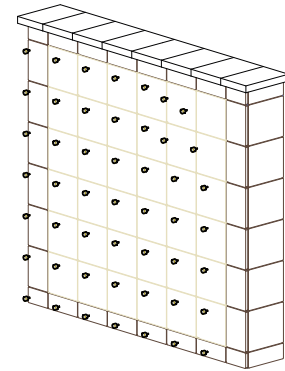

The face plates are fixed using decorative rosettes.

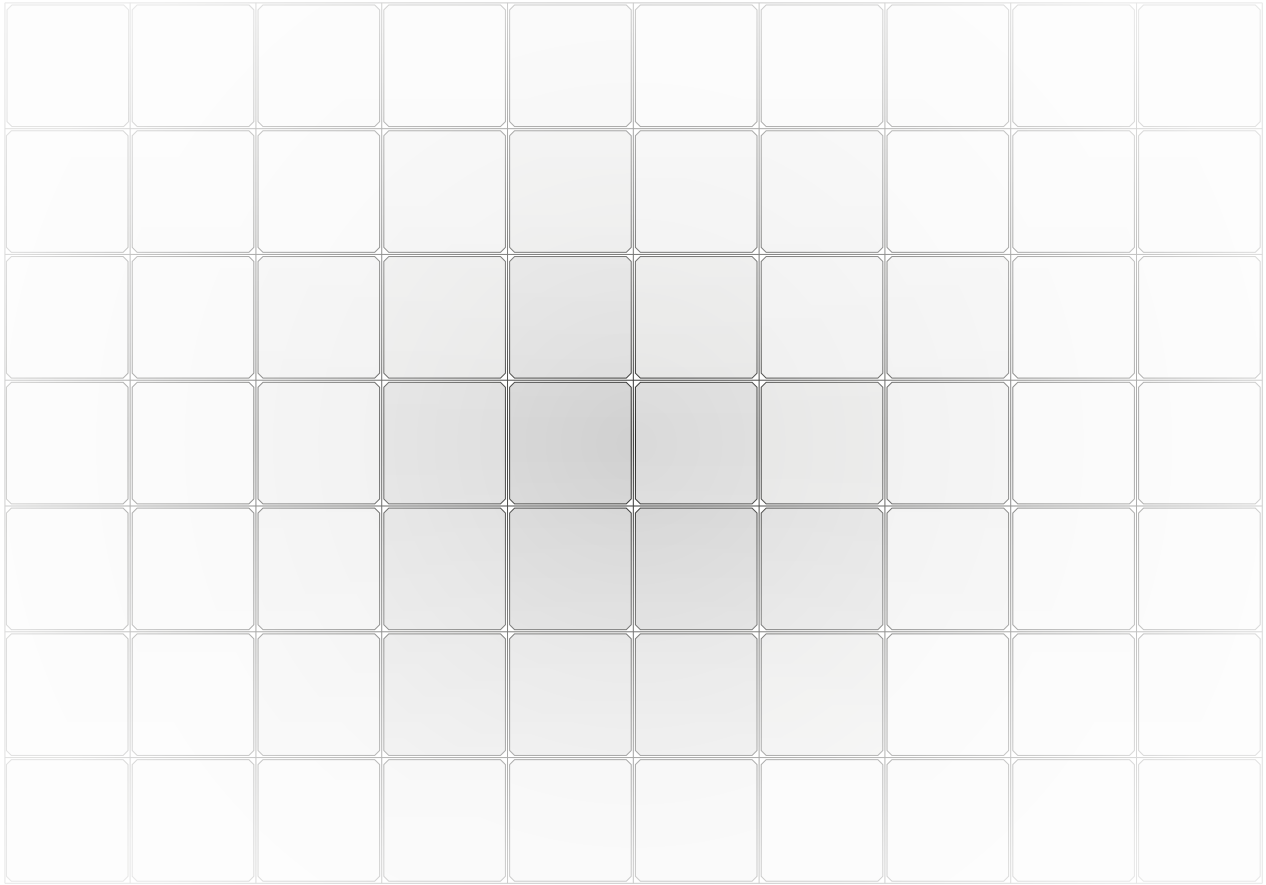



CREMATION NICHE

CREMATION NICHE

Thanks to the MODU-AL system, we can create an additional grave place on the already existing grave, without the need to open it.

The design allows for assembling the smallest segment from a wide range of products. A plastic urn can be conveniently placed in such a niche. There is a wide range of stone patterns to suit to the existing grave.

Compared to the established method of putting additional letters on gravestones, this system is simpler and more efficient. It is also possible to create an additional final resting place, despite the fact that the grave is already full.

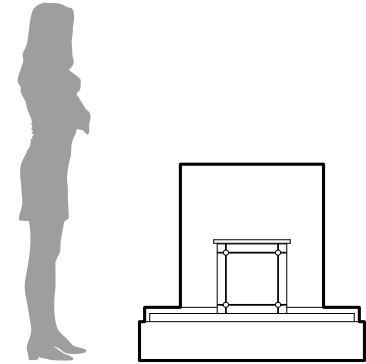

comparison of height

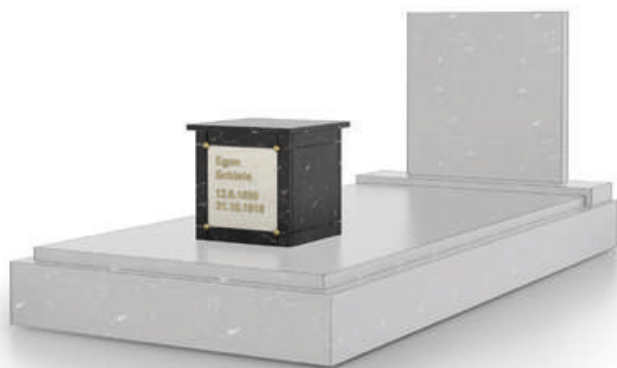

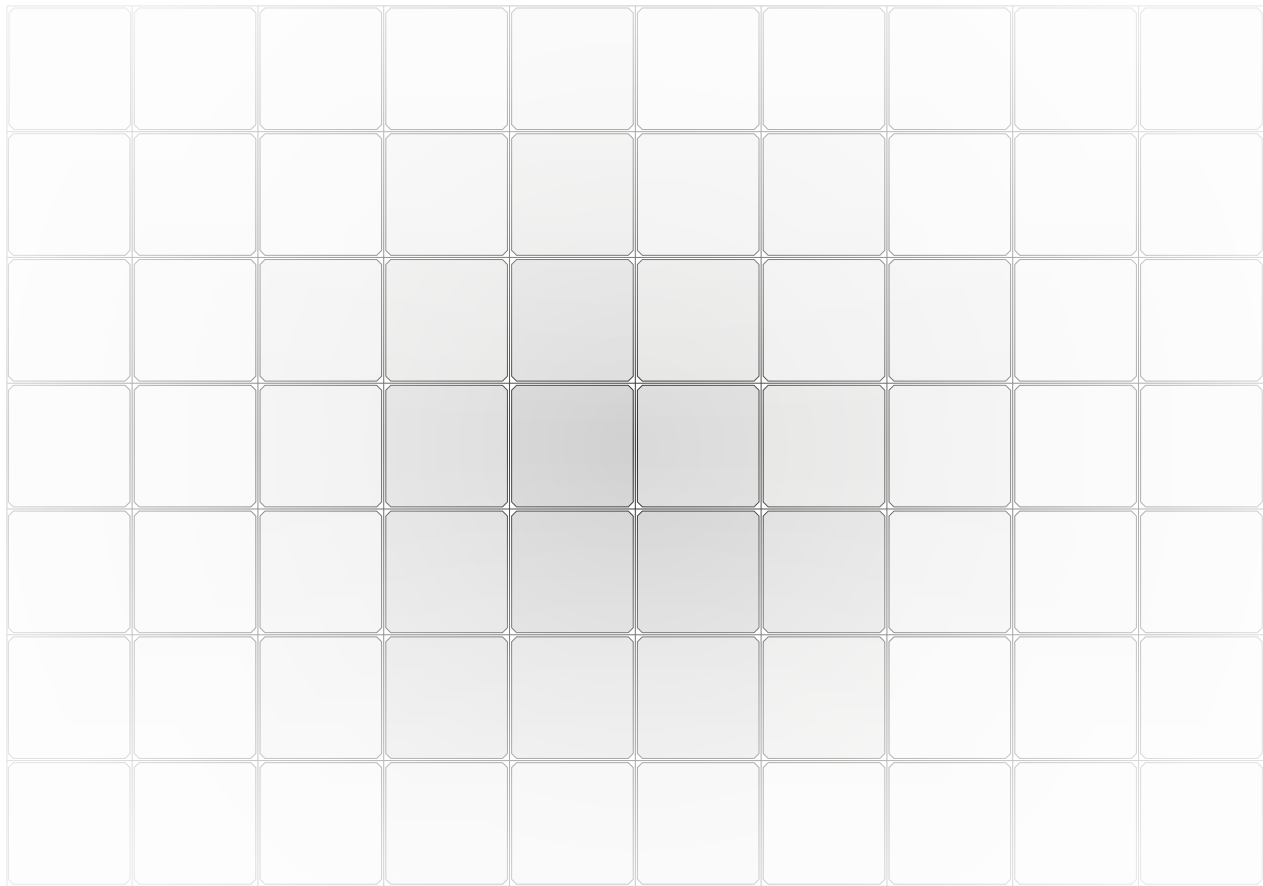



URN GRAVE

URN GRAVE

The modularity of the system has contributed to a unique solution, which brings a number of advantages. The burial urn is placed in the over-ground area. No need for groundwork reconstruction to place the urn, and the manipulation is much easier.

Placement of accessories and stone plates in a vertical form brings extended product life and significantly reduces the need for maintenance and cleaning.

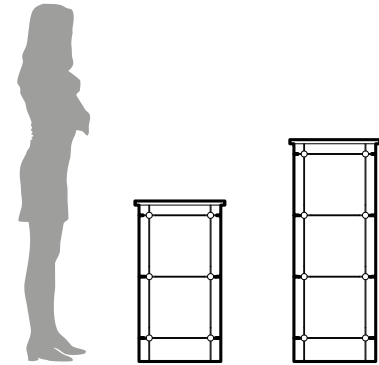

comparison of height



URN GRAVE

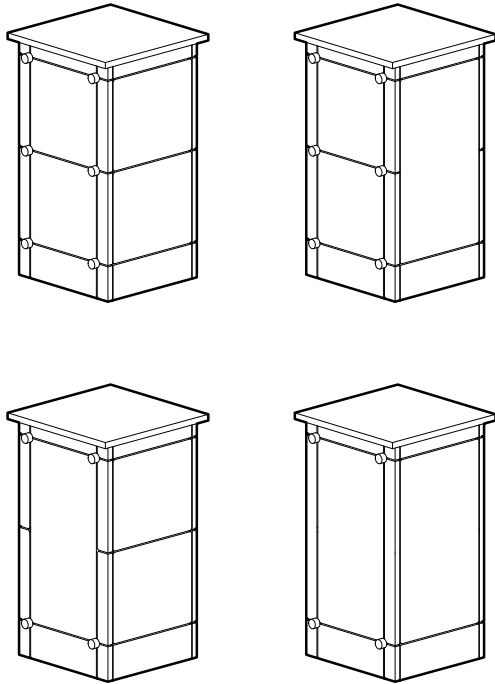

various combinations of stone plate fitting



1. the lantern and vase are fitted to a separate stone plate



2. additional, detachable metal tray for candles



3. tombstones accessories placed on a separate stone plate





PILLAR COLUMBARIUM

PILLAR COLUMBARIUM

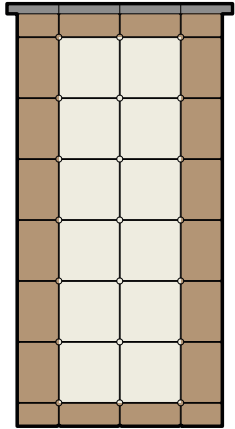

40 x 40

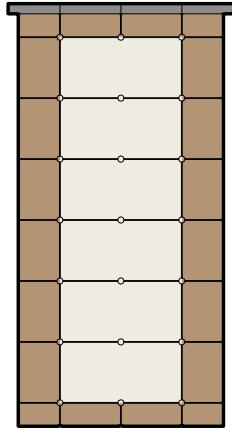

40 x 60

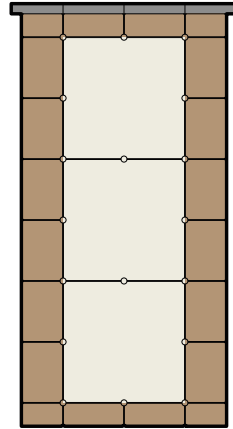

60 x 60

different versions of niche face plate dimensions

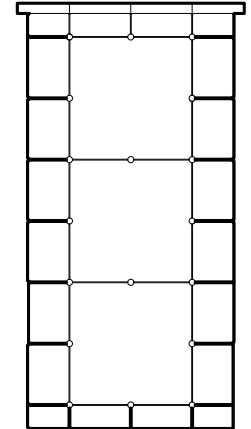

comparison of height



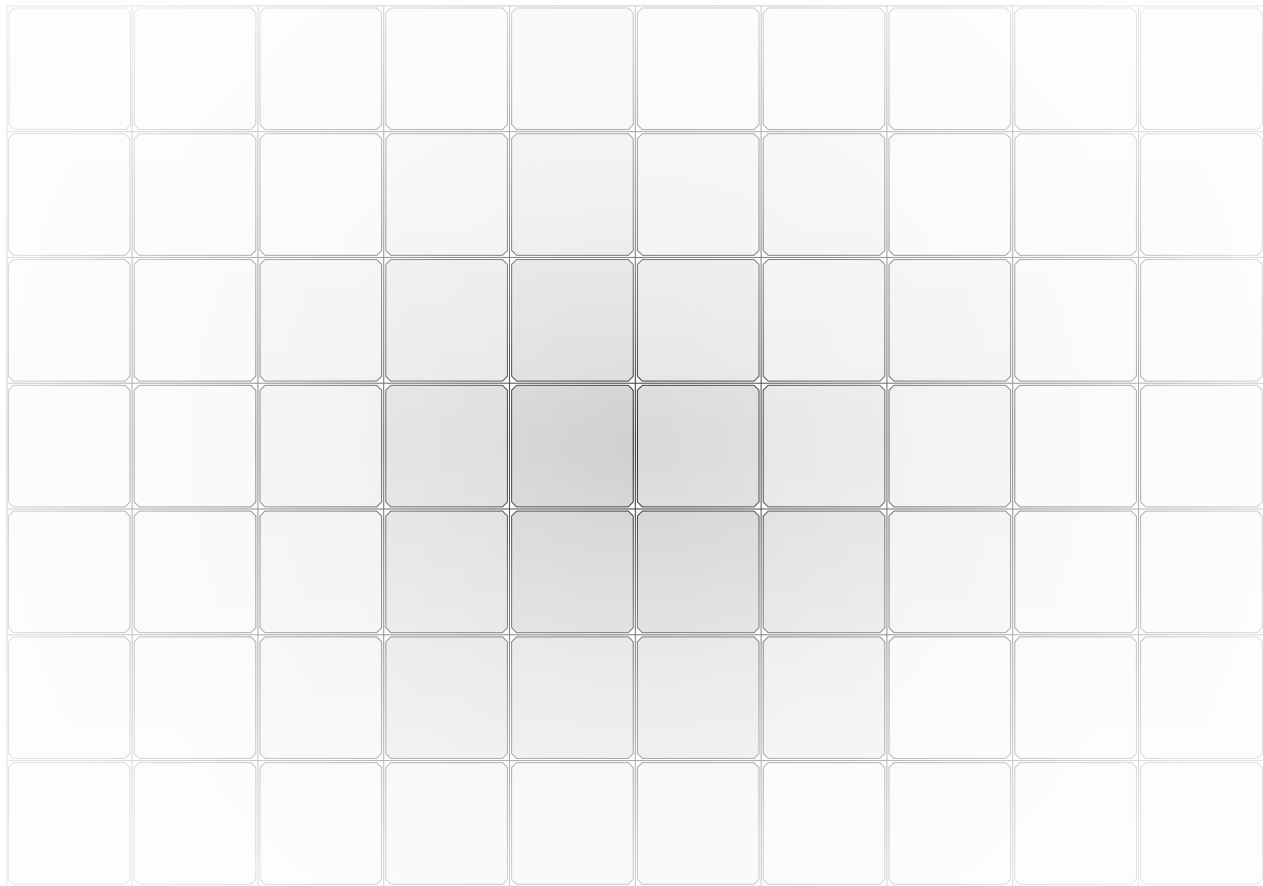



COLUMBARIUM WALL

COLUMBARIUM WALL

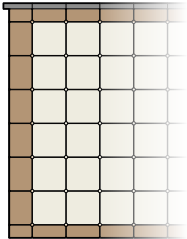

40 x 40

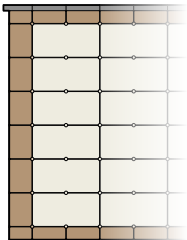

40 x 60

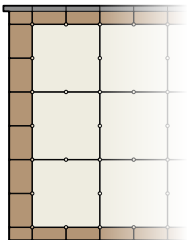

60 x 60

different versions of niche face plate dimensions

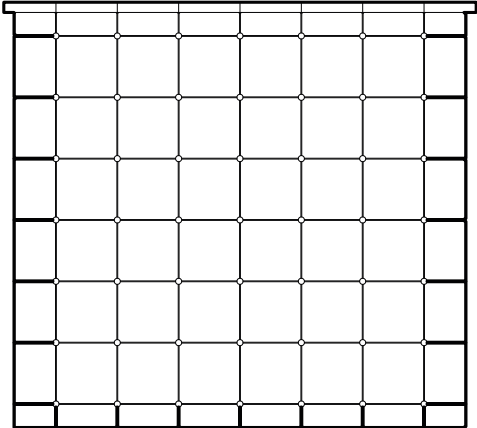

comparison of height



COLUMBARIUM WALL

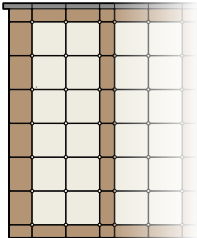

40 x 40

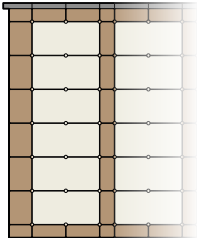

40 x 60

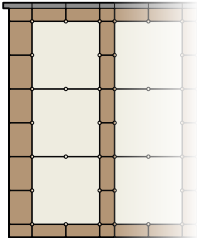

60 x 60

different versions of niche face plate dimensions

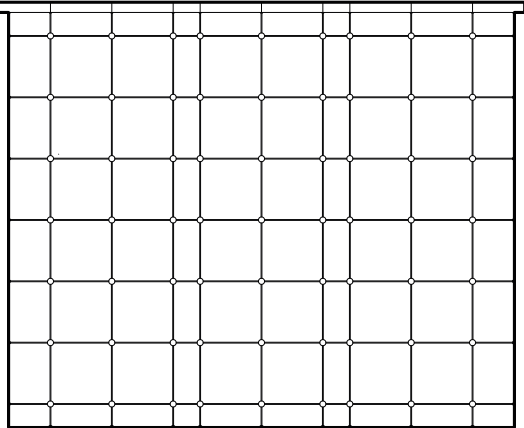

comparison of height



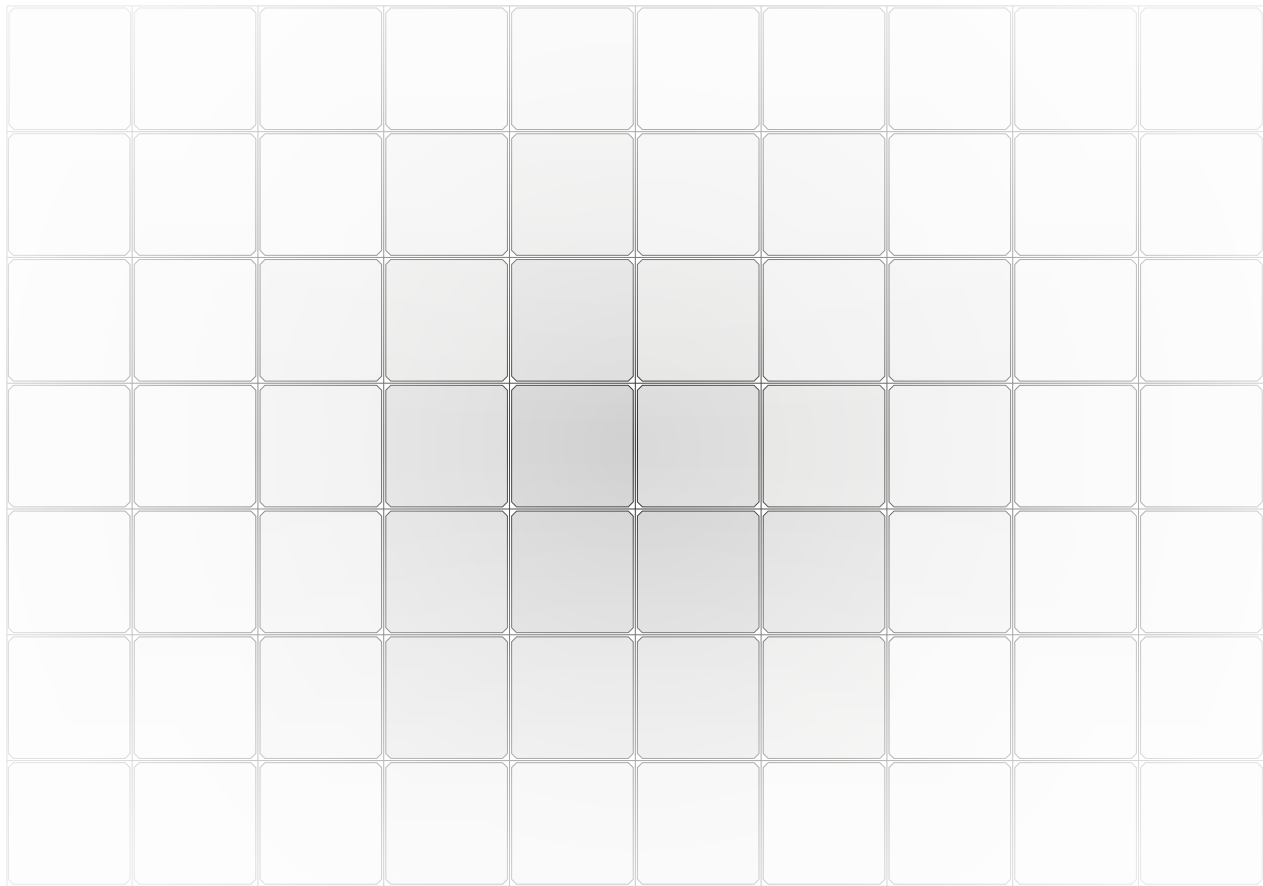



COLUMBARIUM MEMORIAL BUILDING

COLUMBARIUM MEMORIAL BUILDING

The simple, solid structure makes it possible to create countless combinations and sizes. This property enables us to satisfy all customer requirements.

The MODU-AL system meets the mechanical strength requirements of relevant standards, and its modularity and variability make it possible to create new, original designs.

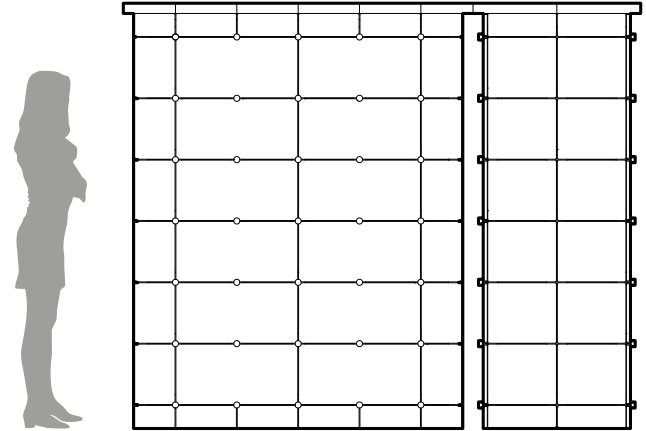

comparison of height



COLUMBARIUM MEMORIAL BUILDING

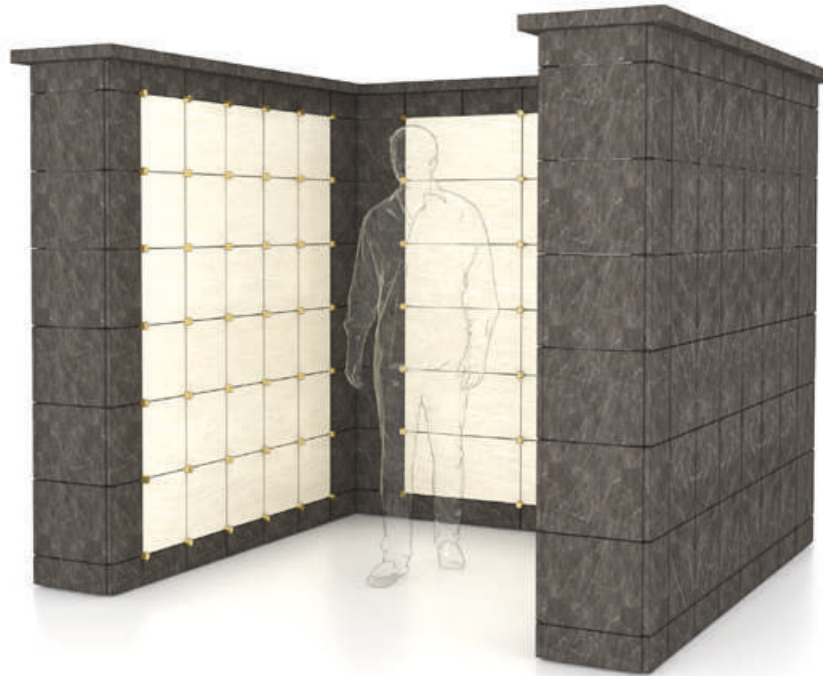

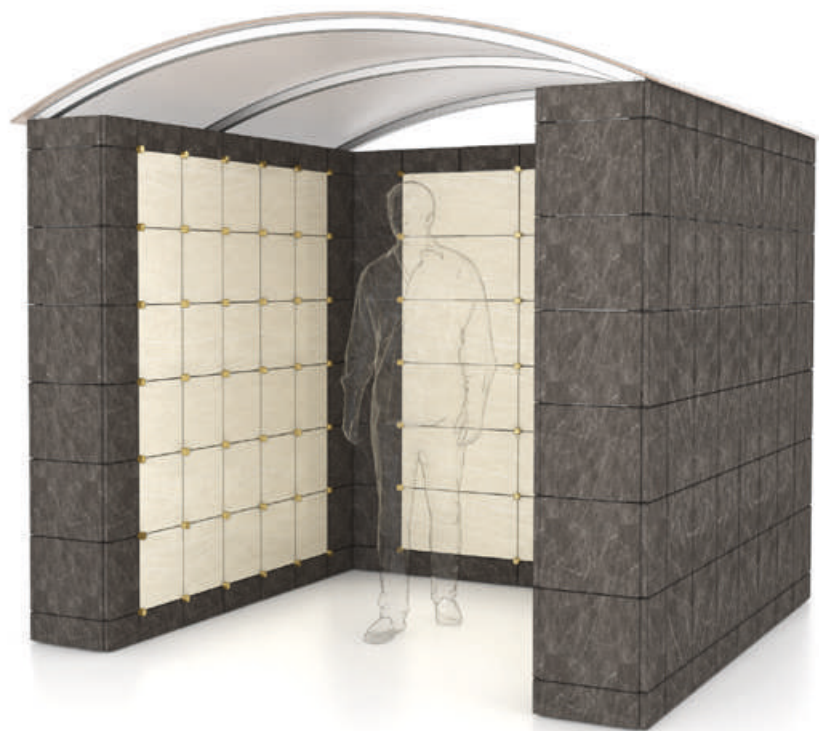

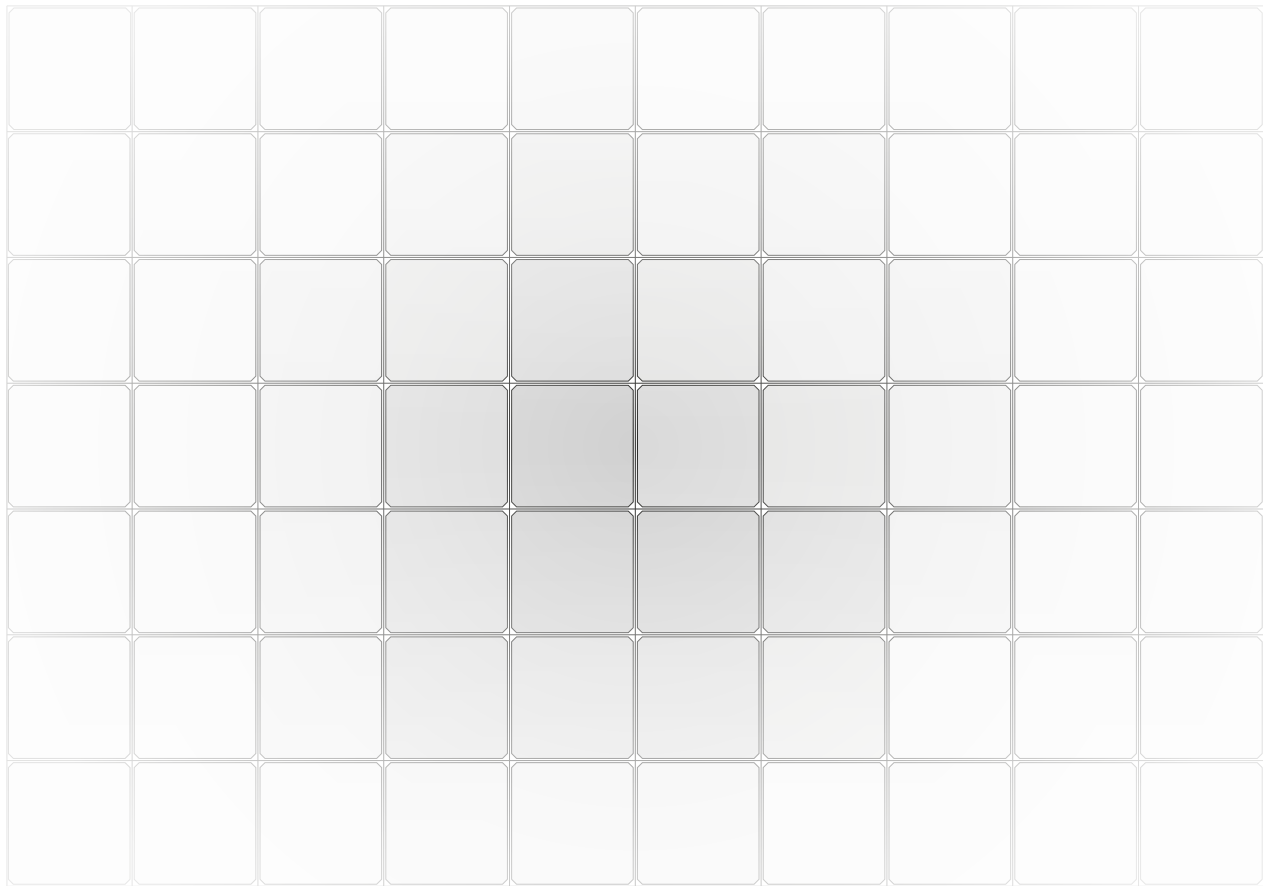



BENEFITS OF THE SYSTEM

BENEFITS OF THE SYSTEM

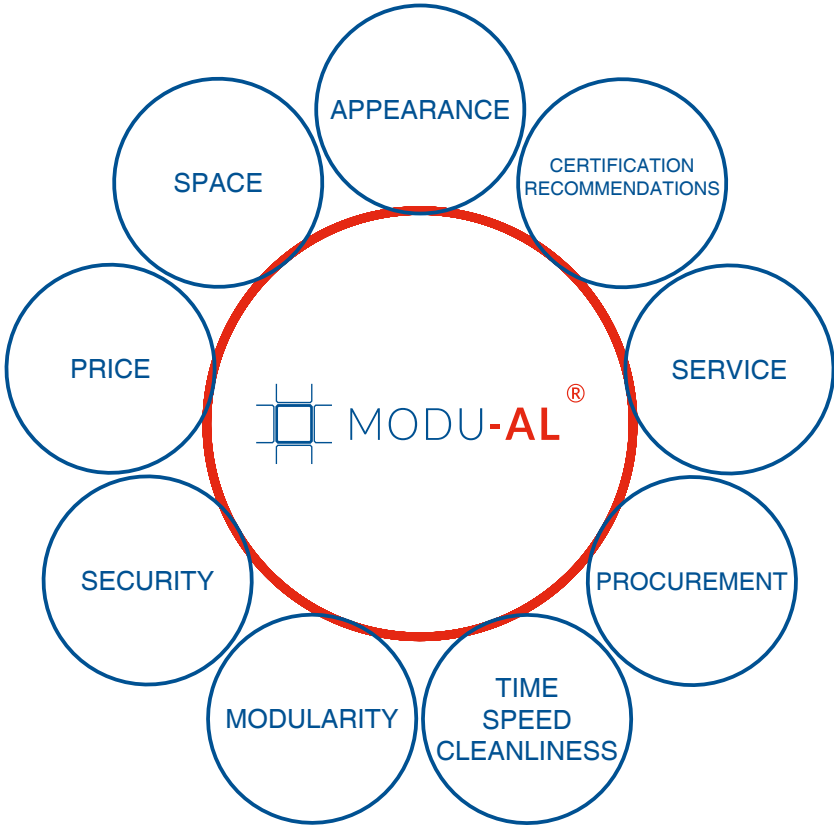

APPEARANCE

- contemporary, unique and aesthetic look with clean lines
- “urban planning” solution
- no “uncompleted” graves

SPACE

- space-saving, compared to “conventional” graves
- 10 times better utilization of space

PRICE

- the best space saving solution
- without the need to invest in concrete casting work

SECURITY

- camera system protection
- each niche has its own sensor

MODULARITY

- the system offers a wide range of options in the number of niches and layout arrangement
- we can place our product anywhere and recommend the best solution

TIME + SPEED + CLEANLINESS

- time-saving and clean realization
- construction speed, within 72 hours (no building work for several months)
- the module does not require concreting (only a concrete socket needs to be created)

PROCUREMENT

- if the implementation is done by our company, we offer favourable terms and methods of financing

SERVICE

- low maintenance
- always without unwanted weeds and untidy graves
- we offer our product service on pre-agreed terms

CERTIFICATION - RECOMMENDATIONS

- Guild of Stonemasons of Slovakia
- Slovak Association of Funeral and Cremation Services
- static report

BENEFITS OF THE SYSTEM



THE END OF THESE SOLUTIONS!

The MODU-AL system brings you new possibilities for storing and venerating the cremated remains of your deceased. It offers an aesthetic and dignified solution, which is financially less demanding than the currently used graves and urn walls. It guarantees the effective extension of cemeteries without the need for enormous land plots, which are scarce now.

SINGLE SIDED WALLS

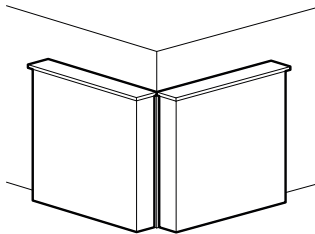

DOUBLE SIDED WALLS

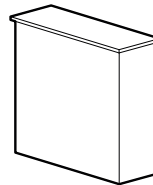

PARALLEL ARRANGEMENT

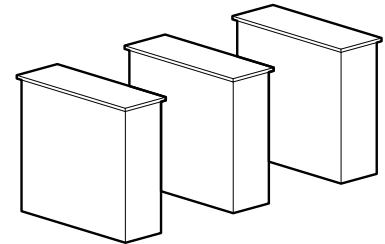

CHAMBER ARRANGEMENT

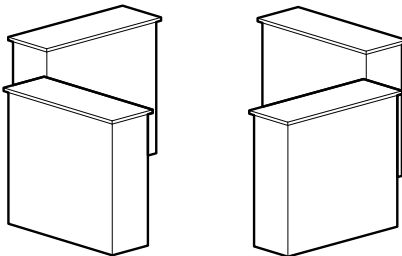

ORTHOGONAL ARRANGEMENT

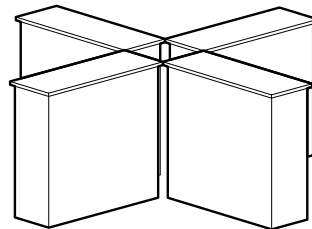

FREE ARRANGEMENT

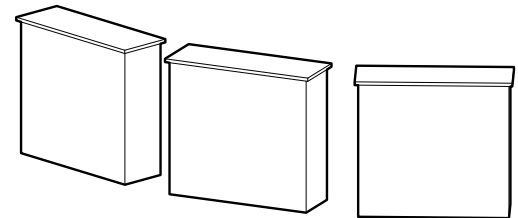

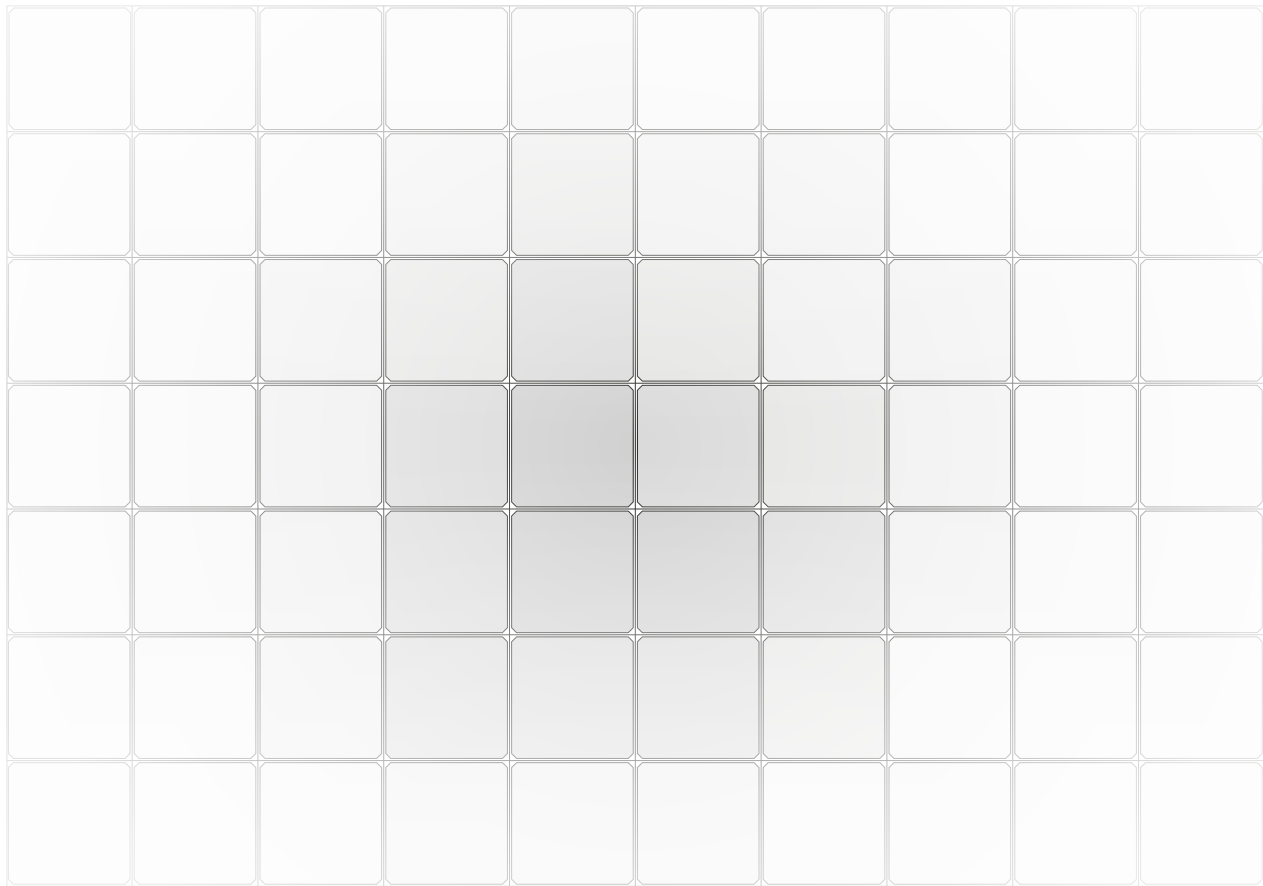



ACCESSORIES

ACCESSORIES

FONT ELEGANTS

AaBbCcDdEeFfGg
HhIiJjKkLlMmNn
OoPpQqRrSsTt
UuVvWwXxYyZz



polished st. steel



gold



black gold



matt silver



bronze

Capital letters

A ↓ 3, 4, 5 cm

small letters

a ↓ 2.3, 3, 3.8 cm

numerals

2 ↓ 2.4cm

diakritics

+ * / v o o

FONT ROMANO

A B C D E F G H I J K
 L M N O P R S T U
 V W X Y Z
 0 1 2 3 4 5 6 7 8 9



polished st. steel



black gold



gold



bronze

letters

A ↓

2.5, 3, 4, 5 cm

numerals

2 ↓

2.5, 3 cm

diacritics

† * / ∨ ◻ ◻

ACCESSORIES

RUSSIAN ALPHABET

А Б В Г Д Е Ж З И
И К Л М Н О П Р С
Т У Ф Х Ц Ч Ш Щ
Ъ Ы Ь Э Ю Я



polished st. steel



black gold



gold



bronze

letters



3, 5 cm

numerals



2.5, 3 cm

diakritics



FONT KARPATIA

A B C D E F G H I
 J K L M N O P Q R
 S T U V W X Y Z

* † 1 2 3 4 5 6 7 8 9 0 Ø Æ Ÿ ,



polished st. steel



black gold



gold



bronze

letters  2.5, 3, 4, 5 cm

numerals  2.5, 3 cm

diakritics 

ACCESSORIES

ELECTRIC LAMP URN LANTERN



20cm x Φ = 7cm



LU01-0-18
polished stainless steel



LU01-1-18
gold



LU01-3-18
black gold



LU01-4-18
brushed stainless steel



LU01-5-18
bronze



11,5cm x Φ = 6cm



L07-0-11n
polished stainless steel



L07-4-11n
brushed stainless steel

CYLINDRICAL VASE



20cm x ϕ = 7cm



10cm x ϕ = 7cm

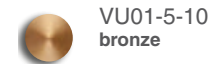
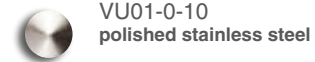

ACCESSORIES

URN VASE



10cm x Φ = 6cm



VU01-0-10 / S15
polished stainless steel



VU01-1-10 / S15
gold



VU01-3-10 / S15
black gold



VU01-4-10 / S15
brushed stainless steel



VU01-5-10 / S15
bronze



16cm x Φ = 6cm



VU02-0-16 / S15
polished stainless steel



VU02-1-16 / S15
gold



VU02-3-16 / S15
black gold



VU02-4-16 / S15
brushed stainless steel



VU02-5-16 / S15
bronze

INSTALLATION – ATTACHMENT



assembly **with gluing**



LARGE TEMPLATE

- very fast and simple application
- free text arrangement
- possibility of applying in vertical position
- just align to the bottom of the monument
- max. template size 600 x 800 mm

BRACKET

niche wall mount



7cm x 7cm
x 3,5cm

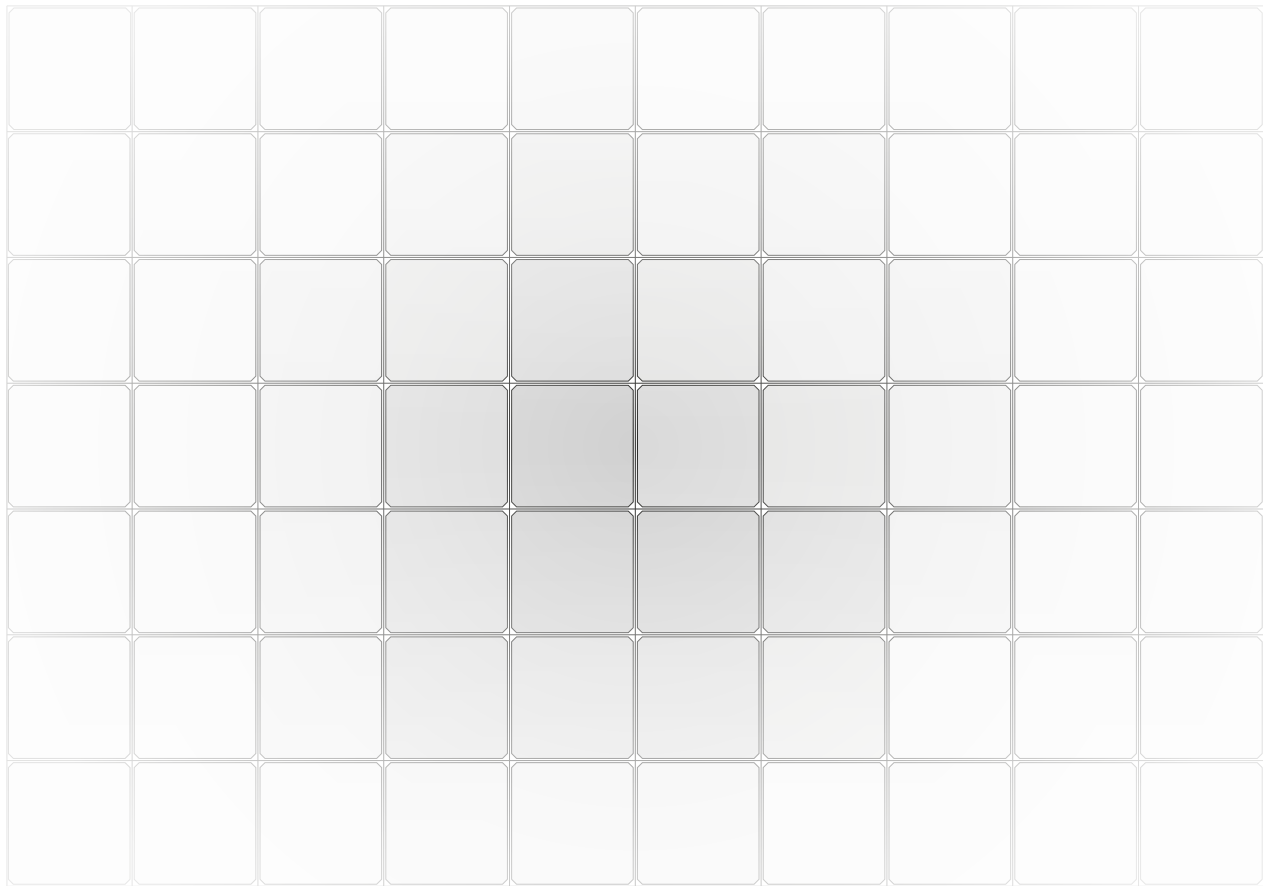



VISUALIZATION

VISUALIZATION





VISUALIZATION





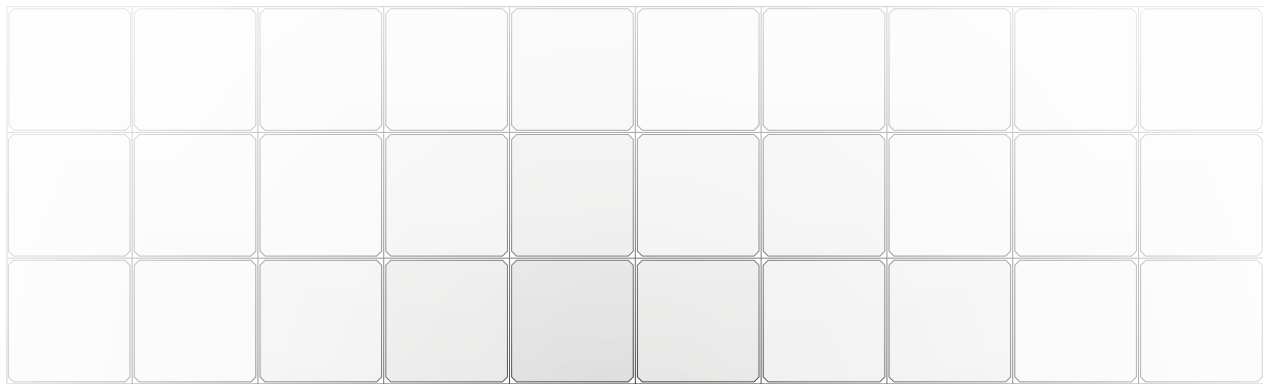

System MODUAL is the trademark of AMV Slovakia, s.r.o. The system, designs and compositions in the catalogue are the copyrighted intellectual property of AMV Slovakia. Distribution, copying or any imitation of the MODUAL system is subject to the authorization of AMV Slovakia.

© 2018

www.iamv.eu / www.amvslovakia.sk / objednavky@amvslovakia.sk / 00 421 35 642 821 4 - 5
Dostojevského 2, 940 63 Nové Zámky, Slovakia

